

Specification

Center Frequency[fo]	395MHz
Bandwidth[BW]	±5.0MHz
Insertion Loss in BW	3.0 dB max.
Ripple in BW	0.5 dB max.
VSWR in BW	1.5:1 max.
Attenuation [Absolute Value]	25.0 min.@ 10 to 350 MHz 10.0 min.@ 410 to 500 MHz 30.0 min.@ 700 to 900 MHz 25.0 min.@ 1000 MHz
In/Out Impedance	50Ω
Input Power	1 w max.
Operation Temperature	-40°C ~ +85 °C

Dimension (mm)

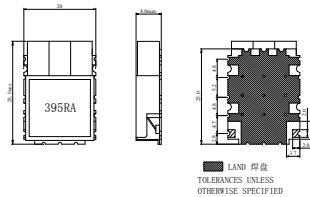

TOLERANCE:±0.3 UNIT:mm

TEST GRAPH

