

Specification

Center Frequency[fo]	5670.0MHz
Bandwidth[BW]	±190MHz
Insertion Loss in BW	1.5 dB max.
Ripple in BW	1.0 dB max.
VSWR in BW	1.9:1max.
Attenuation [Absolute Value]	25.0 min.@ 2400 to 2700 MHz 21.0 min.@ 5140 to 5340 MHz
In/Out Impedance	50Ω
Input Power	1 w max.
Operation Temperature	-40°C ~ +85 °C

Dimension (mm)

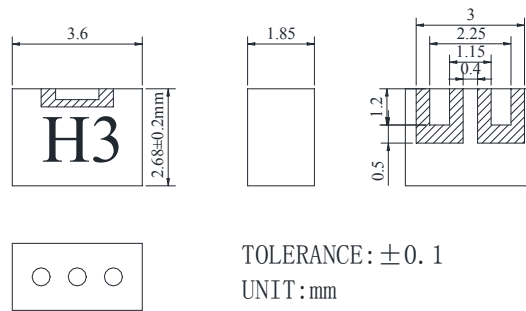

TEST GRAPH

